

## EN1092-1/11B Weld Neck PN16 Flange

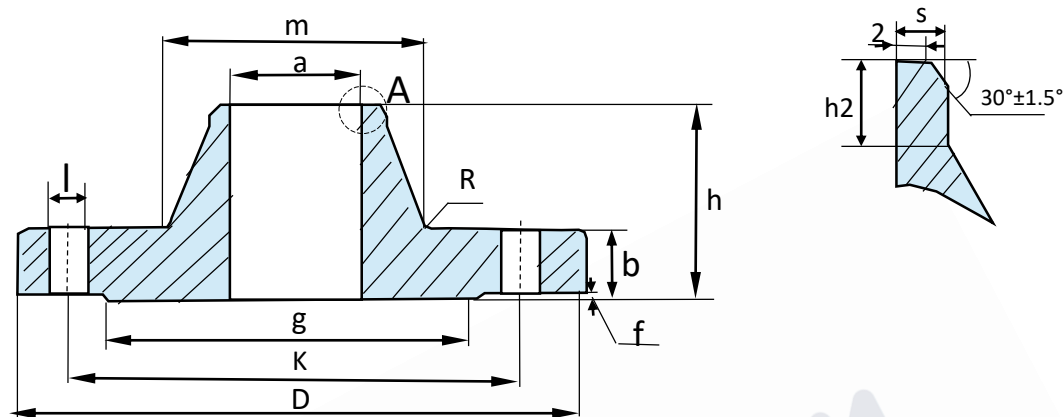

Pipe Nominal size	Flange				Neck				Raised face		Screws			Weight	
in	a	D	b	k	h	m	s	r	h2	g	f	No. of holes	Thread	l	kg
0.50	21.30	95.00	16.00	65.00	38.00	32.00	2.00	4.00	6.00	45.00	2.00	4	M12	14.00	0.77
0.75	26.90	105.00	18.00	75.00	40.00	40.00	2.30	4.00	6.00	58.00	2.00	4	M12	14.00	1.09
1	33.70	115.00	18.00	85.00	40.00	46.00	2.60	4.00	6.00	68.00	2.00	4	M12	14.00	1.30
1.25	42.40	140.00	18.00	100.00	42.00	56.00	2.60	6.00	6.00	78.00	2.00	4	M16	18.00	1.91
1.50	48.30	150.00	18.00	110.00	45.00	64.00	2.60	6.00	7.00	88.00	3.00	4	M16	18.00	2.15
2	60.30	165.00	18.00	125.00	45.00	74.00	2.90	6.00	8.00	102.00	3.00	4	M16	18.00	2.53
2.50	73.03	185.00	18.00	145.00	45.00	92.00	2.90	6.00	10.00	122.00	3.00	4	M16	18.00	3.12
3	88.90	200.00	20.00	16.00	50.00	105.00	3.20	6.00	10.00	138.00	3.00	8	M16	18.00	3.92
4	114.30	220.00	20.00	180.00	52.00	131.00	3.60	8.00	12.00	158.00	3.00	8	M16	18.00	4.62
5	141.30	250.00	22.00	210.00	55.00	156.00	4.00	8.00	12.00	188.00	3.00	8	M16	18.00	6.30
6	168.30	285.00	22.00	240.00	55.00	184.00	4.50	10.00	12.00	212.00	3.00	8	M20	22.00	7.81
8	219.10	340.00	24.00	295.00	62.00	235.00	6.30	10.00	16.00	268.00	3.00	12	M20	22.00	11.50
10	273.00	405.00	26.00	355.00	70.00	292.00	6.30	12.00	16.00	320.00	3.00	12	M24	26.00	16.70
12	323.90	460.00	28.00	410.00	78.00	344.00	7.10	12.00	16.00	378.00	4.00	12	M24	26.00	22.10
14	355.60	520.00	30.00	470.00	82.00	390.00	8.00	12.00	16.00	438.00	4.00	16	M24	26.00	32.80
16	406.40	480.00	32.00	525.00	85.00	445.00	8.00	12.00	16.00	490.00	4.00	16	M27	30.00	41.10
18	457.00	640.00	34.00	285.00	83.00	430.00	8.00	12.00	16.00	550.00	4.00	20	M27	30.00	48.50
20	508.00	715.00	36.00	650.00	84.00	548.00	8.00	12.00	16.00	610.00	4.00	20	M30	33.00	63.40
24	609.60	840.00	40.00	770.00	88.00	670.00	10.00	12.00	18.00	725.00	5.00	20	M33	36.00	96.00